

Gulmohar

A Project by Serene Lifespaces



Plot No. F-33, Sector - 08, Ulwe, Navi Mumbai

PROJECT FEATURES

- Clear Titled CIDCO Transfer plot.
- G + 4 storied Residential Project.
- 1 BHK & 1 RK + Terrace Flats
- Ample Car Parking Space
- Quality Construction with Earthquake Resistance
- R.C.C Frame Structure
- Branded Lift of Reputed Make
- Luxury Amenities

PROJECT AMENITIES

- Flooring Vitrified Flooring in All Rooms.
- Kitchen Granite kitchen platform with S.S. Sink and Designer glazed tiles up to beam level.
- Bath / WC Designer glazed tiles up to door level. Branded Sanitarywares.
- Doors Decorative Laminated Flush Main Doors / Internal Doors.
- Windows Powder Coated Aluminum Sliding Windows with Marble Sill.
- Electrification Concealed Copper Wiring with provision for Cable TV & Phone in Living & Bedroom.
- Water Under Ground and Overhead Water Tank with Adequate Water Storage Capacity.
- Colour Distemper Paint on Internal Walls & 100% Acrylic Emulsion Paint for External Walls.
- Terrace Special Brickbat Water Proofing Treatment

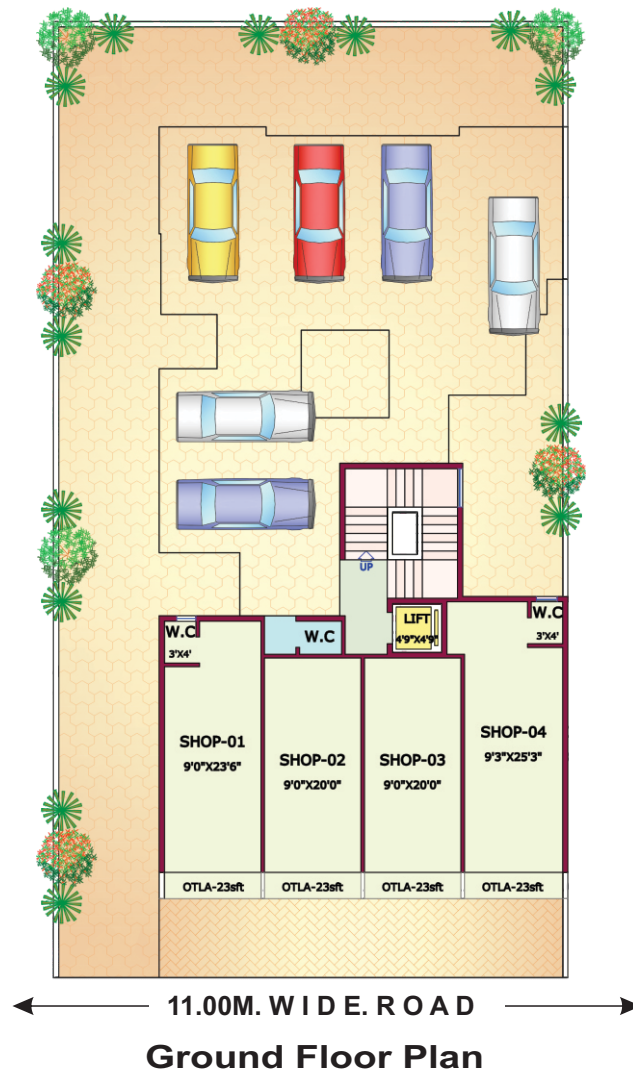

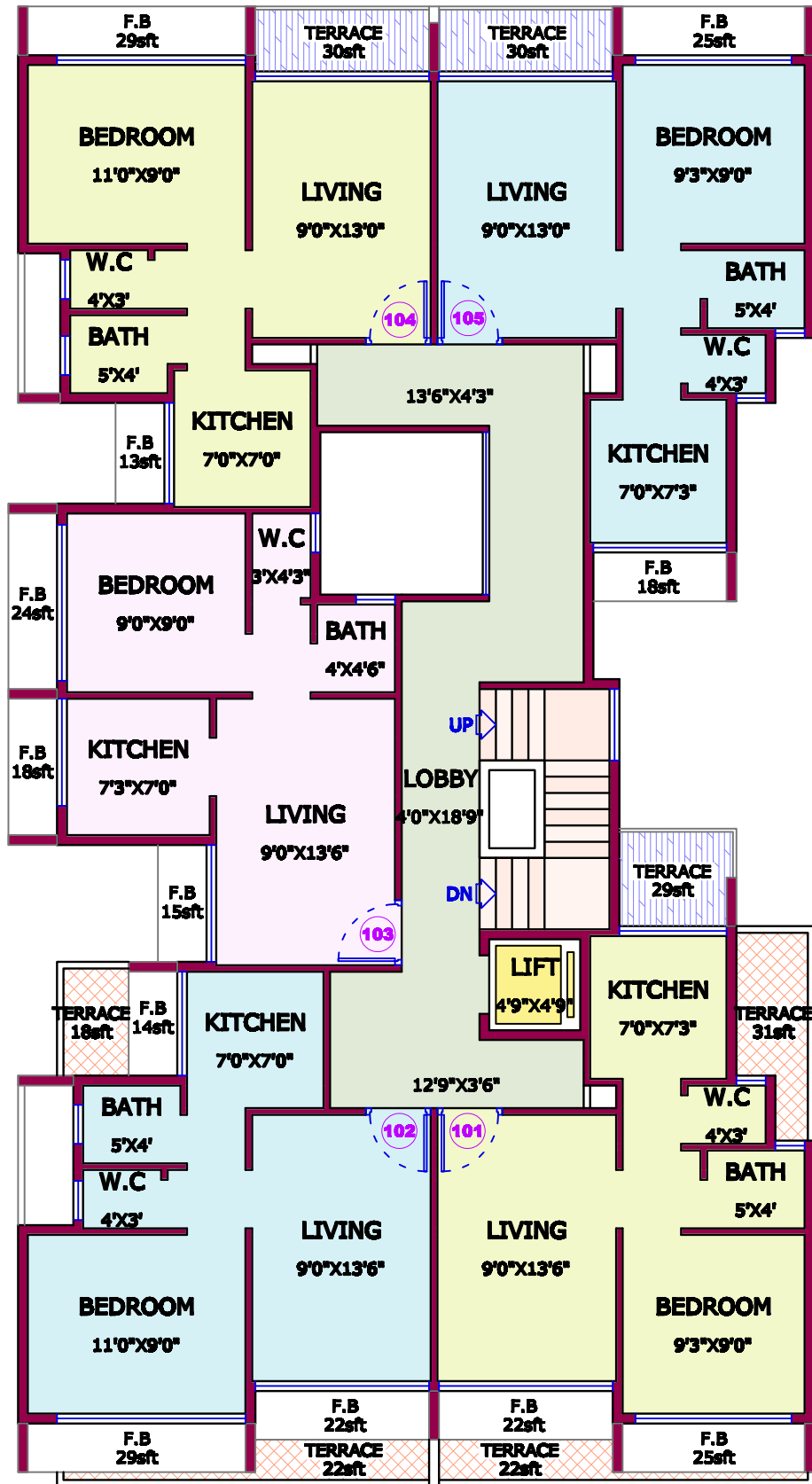

← 11.00M. WIDE. ROAD →

1st Floor Plan



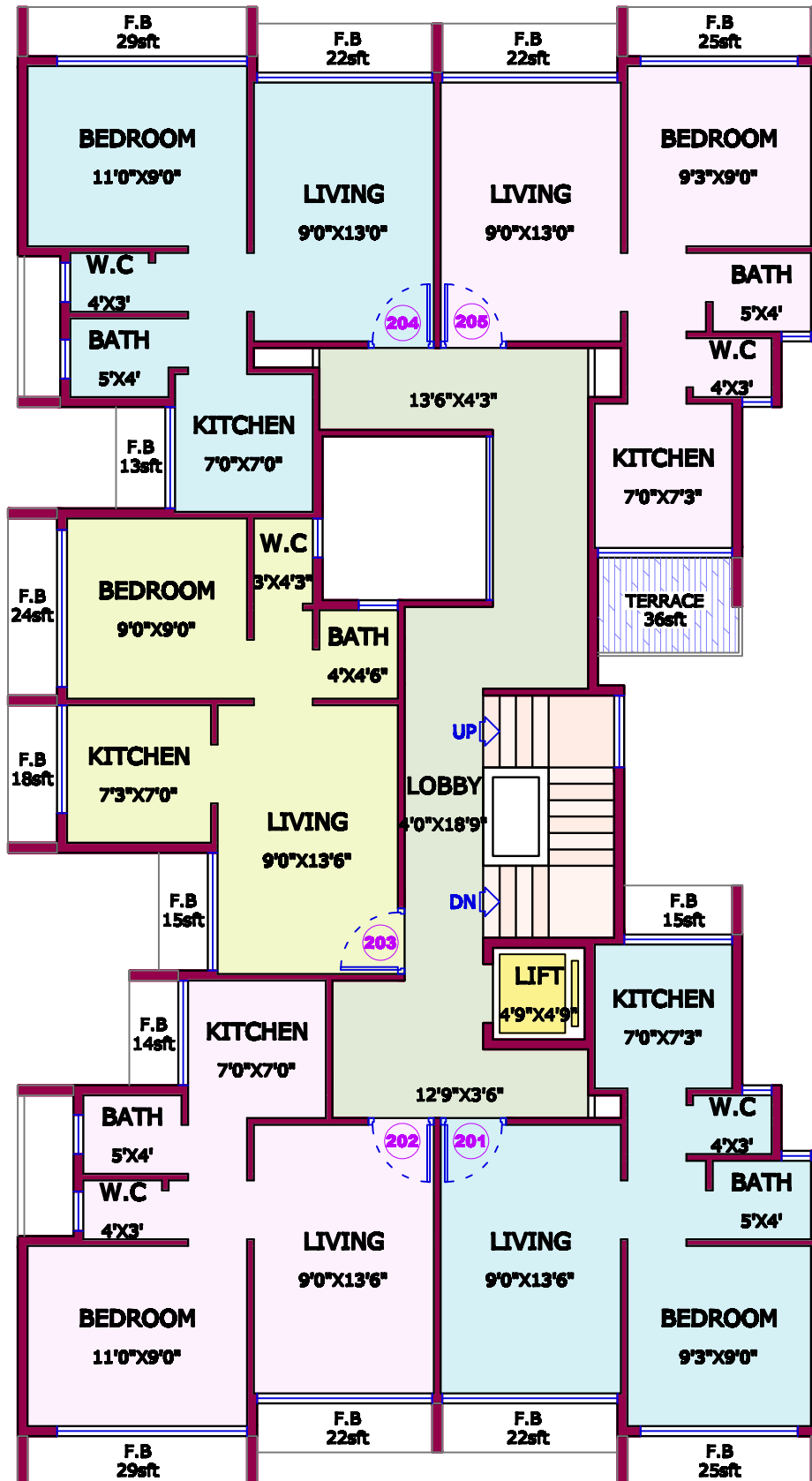

← 11.00M. WIDE. ROAD →

2nd Floor Plan



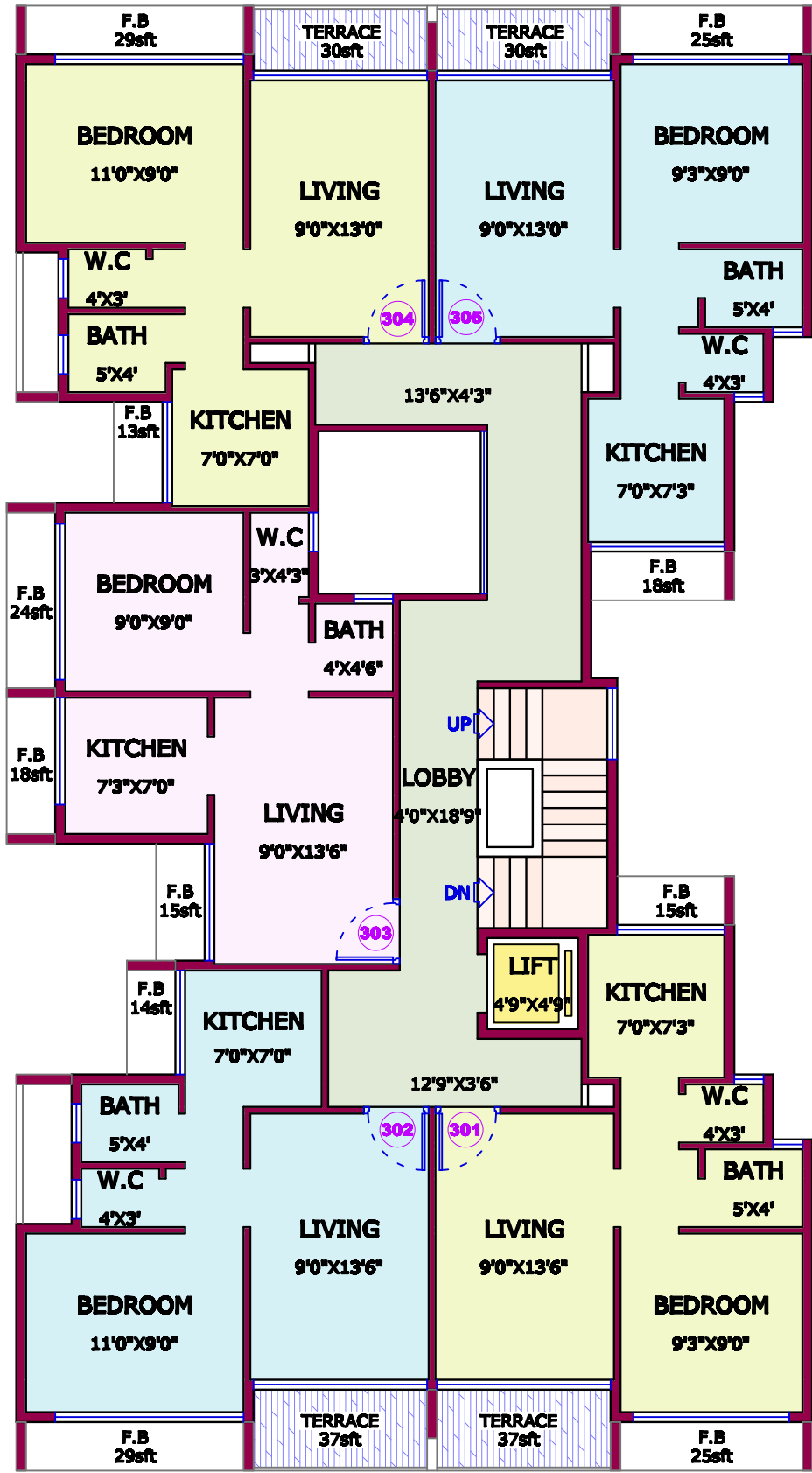

← 11.00M. WIDE. ROAD →

3rd Floor Plan



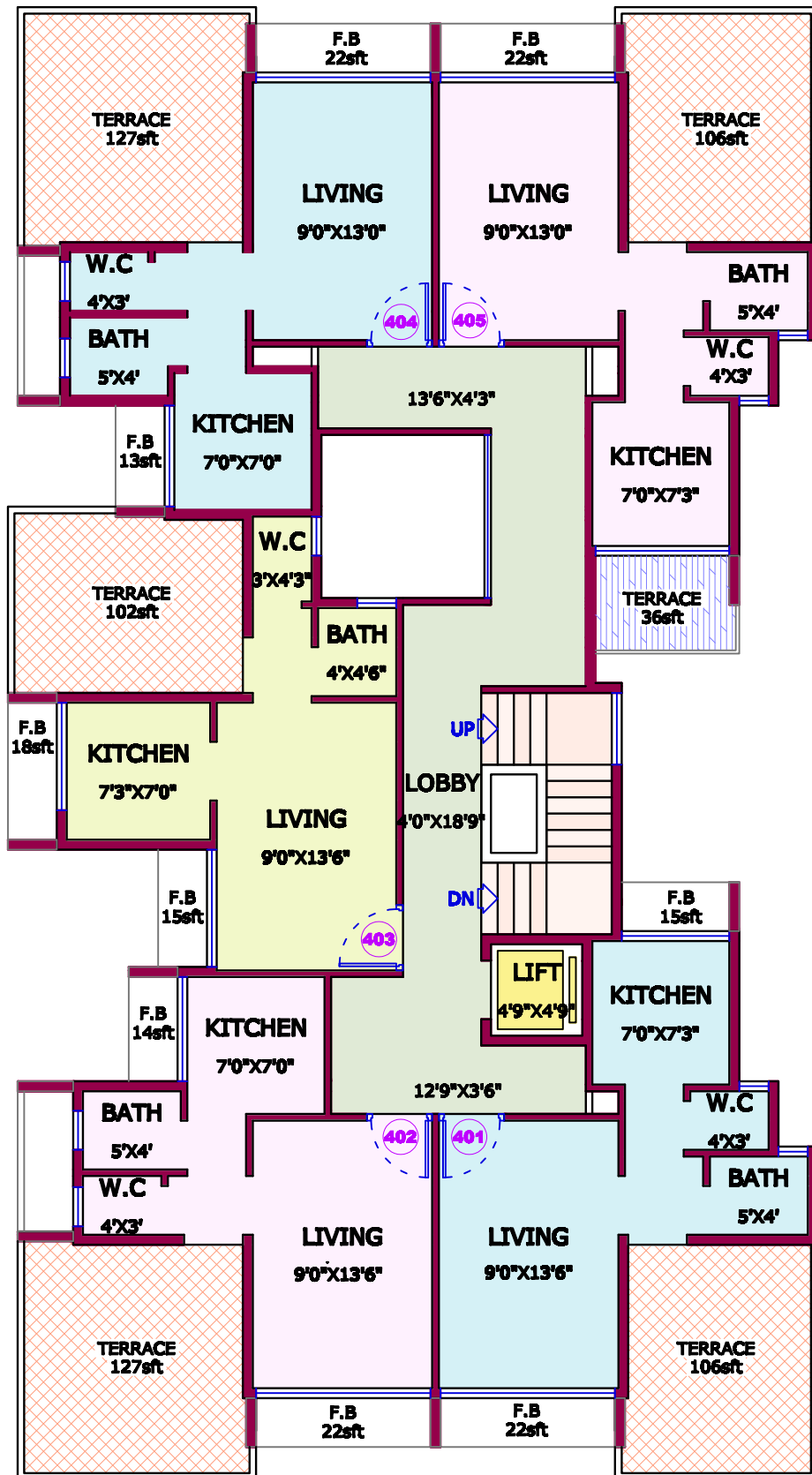

← 11.00M. WIDE. ROAD →

4th Floor Plan



COMPLETED PROJECTS



Lily White
Plot No.21, Sector - 3, Ulwe.



Marigold
Plot No.-125, Sector No-20, Ulwe.



Daffodils
Plot No.-B-23, Sector No-8, Ulwe.

ON GOING PROJECTS



JASMINE
Plot No.152, Sector - 9, Ulwe.



JUHI
Plot No.149, Sector - 9, Ulwe.

UPCOMING PROJECTS



SUNFLOWER
Plot No.130/131, Sector - 20, Ulwe.



Builders & Developers

Legal Advisor:
Adv. Minal B. Khona

Architect:
Triarch Design Studio

R.C.C. Consultant:
Vilas Agharkar

Corp. Office : 202, Damji Shamji Industrial Estate, 2nd Floor, Veera Desai Road, Andheri (W), Mumbai - 400 053
Mob.: +91 98200 50425 | Tel.: +91 22 2673 4475 | Email: serene.lifespaces@yahoo.com

Disclaimer : All plans, drawings, amenities, facilities etc. are subject to the approval of the respective authorities and would be changed, if necessary. Discretion remains with the developers. All rendering and maps are artist's conception and not actual depictions.